

March 16, 2021
School Building Committee

A meeting of the School Building Committee was held on Tuesday, March 16, 2021 at 5:00 pm. Due to current health department restrictions, the meeting was held through remote participation.

Members present by roll call:

	<u>Present</u>
Donald Humason, Jr.	X
Stefan Czaporowski	X
Stacy Burgess	X
Shannon Barry	X
Chris Carey	X
Ramon Diaz	X
Ralph Figy	X
Bryan Forrette	X
Shelly Hazlett	X
Bridget Matthews-Kane	X
Bill Parks	X
Brian Sullivan	X
Cindy Sullivan	X
Tammy Tefft	X
Chris Tolpa	X
Lisa Benoit	<u>X</u>
	16

Also in attendance:

OPM-P3 Representative: Dan Pallotta

Caolo & Bieniek Representatives: Jim Hannifin, Bert Gardner

Cindy Minicucci, Superintendent's Secretary

At 5:00 pm Chairman Donald Humason called the meeting to order.

1. Public participation

Jeffrey Gosselin, Elm Street, Westfield, MA

Mr. Gosselin stated that he was a local educator and worked with Kathy Palmer.

He suggested that a theatre quality/art stage be included in the building plans. He was wondering if anyone gave this any thought. Since this elementary school would be in the downtown area, he felt this would be a great addition.

Dan Pallotta reported that the Massachusetts School Building Authority (MSBA) doesn't reimburse for theatre/art stage at the elementary level. Reimbursement for a theatre/stage is only available at the high school levels. The auditorium/cafeteria plan will be reviewed but will not be a theatre quality stage.

2. Audio recording or video recording of open session: video recording for Channel 15
3. Approval of February 23, 2021 School Building Committee meeting minutes:
Ralph Figy moved, Cindy Sullivan seconded to approve the February 23, 2021 School Building Committee meeting minutes, as presented.

	<u>YES</u>	<u>NO</u>
Donald Humason, Jr.	X	
Stefan Czaporowski	X	
Stacy Burgess	X	
Shannon Barry	X	
Chris Carey	X	
Ramon Diaz	X	
Ralph Figy	X	
Bryan Forrette	X	
Shelly Hazlett	X	
Bridget Matthews-Kane	X	
Bill Parks	X	
Brian Sullivan	X	
Cindy Sullivan	X	
Tammy Tefft	X	
Chris Tolpa	X	
Lisa Benoit	<u>X</u>	
	16	motion passes

4. Update on PSR including design alternatives:
Dan Pallotta reported that, at the request of the Massachusetts School Building Authority (MSBA), the schedule was adjusted by one week. The preferred schematics are now due on Wednesday, April 21, 2021.

Bert Gardner reported that a few representatives visited a renovated elementary school in Hanover, Massachusetts on March 10, 2021.

A PowerPoint presentation was shared (attached). The presentation covered the following topics:

- CBA workflow
- Sustainability Path - LEEDS for Schools and NE CHPS (pros and cons)
- Project Goals
- Neighborhood concepts
- Base Repair
- Add - Reno, 1-story, staggered move
- New Construction, 1-story, staggered move
- New Construction, 2-story, staggered move
- New Construction, 3-story, staggered move
- New Construction, 2-story, single move
- Concept Plan

5. LEEDS vs CHPS preference

The LEEDS for Schools and CHPS compliance paths were reviewed with committee members in the PowerPoint presentation (#4). Pro's and Con's were reviewed. A vote would be in order, at a future meeting, to select LEEDS or CHPS.

6. Set upcoming meeting schedules

Tammy Tefft shared the following School Building Committee meeting dates:

Monday, March 29, 2021 (5-7pm)

Tuesday, April 6, 2021 (5-7pm)

Friday, April 16, 2021 (5-6pm)

She informed committee members that at the April 16, 2021 meeting, two (2) votes would be in order. One vote was needed to select either LEEDS or CHPS and another vote for the Preferred Schematic Design to be submitted to MSBA.

7. Any other items not reasonably anticipated 48 hours prior to the meeting.

8. Adjourn

At 6:15 pm Ramon Diaz moved, Ralph Figy seconded to adjourn the meeting.

	<u>YES</u>	<u>NO</u>
Donald Humason, Jr.	X	
Stefan Czaporowski	X	
Stacy Burgess	X	
Shannon Barry	X	
Chris Carey	left at 5:30 pm	
Ramon Diaz	X	
Ralph Figy	X	
Bryan Forrette	X	
Shelly Hazlett	X	
Bridget Matthews-Kane	X	
Bill Parks	X	
Brian Sullivan	X	
Cindy Sullivan	X	
Tammy Tefft	X	
Chris Tolpa	X	
Lisa Benoit	<u>X</u>	
	15	motion passes

A true copy, Attest:

Donald Humason, Jr. Chair
Westfield School Building
Westfield School Committee

DH/cm

Minutes approved: _____

Westfield Elementary School Project

Informational Update

School Building Committee Meeting
March 16, 2021



CAOLO & BIENIEK ASSOCIATES, INC.
ARCHITECTURE PLANNING INTERIOR DESIGN
521 East Street
Chicopee, Massachusetts 1 413.594.2800
www.cbaarchitects.net

Hanover Field Trip:



CAOLO & BIENIEK ASSOCIATES, INC.
ARCHITECTURE PLANNING INTERIOR DESIGN
521 East Street
Chicopee, Massachusetts 1 413.594.2800
www.cbaarchitects.net

CBA Workflow:

School Building Committee:

- Meet Monthly, or as Required
- Approve All Major Design Decisions, Typically Based on Recommendations of Sub-Committees

School Department Design Sub-Committee:

- Share Project Developments Electronically Between Meetings
- Meet Approximately Every Two Weeks
- Advise On Educational Needs and Responsiveness of Design Options Developed

Public Outreach:

- Purpose:
 - Describe the MSBA Process
 - Describe the Design Process
 - Provide Updated Project Information and Forum for Community Feedback
 - Timing of Information?



CAOLO & BIENIEK ASSOCIATES, INC.
 ARCHITECTURE PLANNING INTERIOR DESIGN
 521 East Street 1413 594 2800
 Chicopee, Massachusetts www.cbaarchitects.net

Sustainability Path – LEED for Schools:

1	2	3	4	5	6	7	8	9	10	11	12	13	14	15	16	17	18	19	20	21	22	23	24	25	26	27	28	29	30	31	32	33	34	35	36	37	38	39	40	41	42	43	44	45	46	47	48	49	50	51	52	53	54	55	56	57	58	59	60	61	62	63	64	65	66	67	68	69	70	71	72	73	74	75	76	77	78	79	80	81	82	83	84	85	86	87	88	89	90	91	92	93	94	95	96	97	98	99	100
1 INTEGRATIVE PROCESS										11 MATERIALS & RESOURCES										22 INNOVATION										33 PROJECT TOTALS (Credit/Points Estimation)																																																																					
1.1 IP1: Integrative Process										11.1 MR1: Storage and Collection of Recyclables										22.1 IN1: Innovation - Purchasing Leases										33.1 P1: Regional Priority Credit (1.0-1.0 Points)																																																																					
2 LOCATION & TRANSPORTATION										11.2 MR2: Construction and Demolition Waste Management Planning										22.2 IN2: Innovation - Economic and OPI Analysis of Mechanical Systems										33.2 P2: Regional Priority Credit (1.0-1.0 Points)																																																																					
2.1 LT1: LEED for Neighborhood Development Location										11.3 MR3: Building Life-Cycle Impact Reduction										22.3 IN3: Innovation - TBO										33.3 P3: Regional Priority Credit (1.0-1.0 Points)																																																																					
2.2 LT2: Sensitive Land Protection										11.4 MR4: Building Product Disclosure and Optimization - EPD										22.4 IN4: Innovation - TBO										33.4 P4: Regional Priority Credit (1.0-1.0 Points)																																																																					
2.3 LT3: High Priority Site										11.5 MR5: Building Product Disclosure and Optimization - Sourcing of Raw Materials										22.5 IN5: Innovation - TBO										33.5 P5: Regional Priority Credit (1.0-1.0 Points)																																																																					
2.4 LT4: Sustainable Sites and Context Maps										11.6 MR6: Building Product Disclosure and Optimization - Material Ingredients										22.6 IN6: Innovation - TBO										33.6 P6: Regional Priority Credit (1.0-1.0 Points)																																																																					
2.5 LT5: Access to Quality Transit										11.7 MR7: Construction and Demolition Waste Management										22.7 IN7: Innovation - TBO										33.7 P7: Regional Priority Credit (1.0-1.0 Points)																																																																					
2.6 LT6: Bicycles Facilities										12 EQ: ENVIRONMENTAL QUALITY										22.8 IN8: Innovation - TBO										33.8 P8: Regional Priority Credit (1.0-1.0 Points)																																																																					
2.7 LT7: Reduced Parking Footprint										12.1 EQ1: Minimum Indoor Air Quality Performance										22.9 IN9: Innovation - TBO										33.9 P9: Regional Priority Credit (1.0-1.0 Points)																																																																					
2.8 LT8: Green Vehicles										12.2 EQ2: Environmental Tobacco Smoke Control										22.10 IN10: Innovation - TBO										33.10 P10: Regional Priority Credit (1.0-1.0 Points)																																																																					
3 SUSTAINABLE SITES										12.3 EQ3: Minimum Acoustic Performance										22.11 IN11: Innovation - TBO										33.11 P11: Regional Priority Credit (1.0-1.0 Points)																																																																					
3.1 SS1: Construction Activity Pollution Prevention										12.4 EQ4: Enhanced Indoor Air Quality Strategies										22.12 IN12: Innovation - TBO										33.12 P12: Regional Priority Credit (1.0-1.0 Points)																																																																					
3.2 SS2: Environmental Site Assessment										12.5 EQ5: Low-Emitting Materials										22.13 IN13: Innovation - TBO										33.13 P13: Regional Priority Credit (1.0-1.0 Points)																																																																					
3.3 SS3: Site Assessment										12.6 EQ6: Construction Indoor Air Quality Management Plan										22.14 IN14: Innovation - TBO										33.14 P14: Regional Priority Credit (1.0-1.0 Points)																																																																					
3.4 SS4: Site Development - Protect or Restore Habitat										12.7 EQ7: IAQ Assessment										22.15 IN15: Innovation - TBO										33.15 P15: Regional Priority Credit (1.0-1.0 Points)																																																																					
3.5 SS5: Open Space										12.8 EQ8: Thermal Comfort										22.16 IN16: Innovation - TBO										33.16 P16: Regional Priority Credit (1.0-1.0 Points)																																																																					
3.6 SS6: Stormwater Management										12.9 EQ9: Indoor Lighting										22.17 IN17: Innovation - TBO										33.17 P17: Regional Priority Credit (1.0-1.0 Points)																																																																					
3.7 SS7: Heat Island Reduction										12.10 EQ10: Daylight										22.18 IN18: Innovation - TBO										33.18 P18: Regional Priority Credit (1.0-1.0 Points)																																																																					
3.8 SS8: Light Pollution Reduction										12.11 EQ11: Quality Views										22.19 IN19: Innovation - TBO										33.19 P19: Regional Priority Credit (1.0-1.0 Points)																																																																					
3.9 SS9: Site Master Plan										12.12 EQ12: Acoustic Performance										23 IP: INNOVATION										33.20 P20: Regional Priority Credit (1.0-1.0 Points)																																																																					
3.10 SS10: Joint Use of Facilities										23 IP: INNOVATION										33.21 P21: Regional Priority Credit (1.0-1.0 Points)																																																																															
4 WATER EFFICIENCY										24 EA: ENERGY & AMBIENCE										33.22 P22: Regional Priority Credit (1.0-1.0 Points)																																																																															
4.1 WE1: Outdoor Water Use Reduction										24.1 EA1: Fundamental Commissioning and Verification										33.23 P23: Regional Priority Credit (1.0-1.0 Points)																																																																															
4.2 WE2: Indoor Water Use Reduction										24.2 EA2: User-run Energy Performance										33.24 P24: Regional Priority Credit (1.0-1.0 Points)																																																																															
4.3 WE3: Building Level Water Metering										24.3 EA3: Building-Level Energy Monitoring										33.25 P25: Regional Priority Credit (1.0-1.0 Points)																																																																															
4.4 WE4: Outdoor Water Use Reduction										24.4 EA4: Fundamental Refrigerant Management										33.26 P26: Regional Priority Credit (1.0-1.0 Points)																																																																															
4.5 WE5: Indoor Water Use Reduction										24.5 EA5: Enhanced Commissioning										33.27 P27: Regional Priority Credit (1.0-1.0 Points)																																																																															
4.6 WE6: Cooling Tower Water Use										24.6 EA6: Sustainable Energy End-Use										33.28 P28: Regional Priority Credit (1.0-1.0 Points)																																																																															
4.7 WE7: Water Metering										24.7 EA7: Advanced Energy Monitoring										33.29 P29: Regional Priority Credit (1.0-1.0 Points)																																																																															
5 ENERGY & AMBIENCE										24.8 EA8: Demand Response										33.30 P30: Regional Priority Credit (1.0-1.0 Points)																																																																															
5.1 EA1: Fundamental Commissioning and Verification										24.9 EA9: Renewable Energy Production										33.31 P31: Regional Priority Credit (1.0-1.0 Points)																																																																															
5.2 EA2: User-run Energy Performance										24.10 EA10: Enhanced Refrigerant Management										33.32 P32: Regional Priority Credit (1.0-1.0 Points)																																																																															
5.3 EA3: Building-Level Energy Monitoring										24.11 EA11: Green Power and Carbon Offsets										33.33 P33: Regional Priority Credit (1.0-1.0 Points)																																																																															
5.4 EA4: Fundamental Refrigerant Management										33.34 P34: Regional Priority Credit (1.0-1.0 Points)										33.35 P35: Regional Priority Credit (1.0-1.0 Points)																																																																															
5.5 EA5: Enhanced Commissioning										33.36 P36: Regional Priority Credit (1.0-1.0 Points)										33.37 P37: Regional Priority Credit (1.0-1.0 Points)																																																																															
5.6 EA6: Sustainable Energy End-Use										33.38 P38: Regional Priority Credit (1.0-1.0 Points)										33.39 P39: Regional Priority Credit (1.0-1.0 Points)																																																																															
5.7 EA7: Advanced Energy Monitoring										33.40 P40: Regional Priority Credit (1.0-1.0 Points)										33.41 P41: Regional Priority Credit (1.0-1.0 Points)																																																																															
5.8 EA8: Demand Response										33.42 P42: Regional Priority Credit (1.0-1.0 Points)										33.43 P43: Regional Priority Credit (1.0-1.0 Points)																																																																															
5.9 EA9: Renewable Energy Production										33.44 P44: Regional Priority Credit (1.0-1.0 Points)										33.45 P45: Regional Priority Credit (1.0-1.0 Points)																																																																															
5.10 EA10: Enhanced Refrigerant Management										33.46 P46: Regional Priority Credit (1.0-1.0 Points)										33.47 P47: Regional Priority Credit (1.0-1.0 Points)																																																																															
5.11 EA11: Green Power and Carbon Offsets										33.48 P48: Regional Priority Credit (1.0-1.0 Points)										33.49 P49: Regional Priority Credit (1.0-1.0 Points)																																																																															
5.12 EA12: Green Power and Carbon Offsets										33.50 P50: Regional Priority Credit (1.0-1.0 Points)										33.51 P51: Regional Priority Credit (1.0-1.0 Points)																																																																															
5.13 EA13: Green Power and Carbon Offsets										33.52 P52: Regional Priority Credit (1.0-1.0 Points)										33.53 P53: Regional Priority Credit (1.0-1.0 Points)																																																																															
5.14 EA14: Green Power and Carbon Offsets										33.54 P54: Regional Priority Credit (1.0-1.0 Points)										33.55 P55: Regional Priority Credit (1.0-1.0 Points)																																																																															
5.15 EA15: Green Power and Carbon Offsets										33.56 P56: Regional Priority Credit (1.0-1.0 Points)										33.57 P57: Regional Priority Credit (1.0-1.0 Points)																																																																															
5.16 EA16: Green Power and Carbon Offsets										33.58 P58: Regional Priority Credit (1.0-1.0 Points)										33.59 P59: Regional Priority Credit (1.0-1.0 Points)																																																																															
5.17 EA17: Green Power and Carbon Offsets										33.60 P60: Regional Priority Credit (1.0-1.0 Points)										33.61 P61: Regional Priority Credit (1.0-1.0 Points)																																																																															
5.18 EA18: Green Power and Carbon Offsets										33.62 P62: Regional Priority Credit (1.0-1.0 Points)										33.63 P63: Regional Priority Credit (1.0-1.0 Points)																																																																															
5.19 EA19: Green Power and Carbon Offsets										33.64 P64: Regional Priority Credit (1.0-1.0 Points)										33.65 P65: Regional Priority Credit (1.0-1.0 Points)																																																																															
5.20 EA20: Green Power and Carbon Offsets										33.66 P66: Regional Priority Credit (1.0-1.0 Points)										33.67 P67: Regional Priority Credit (1.0-1.0 Points)																																																																															
5.21 EA21: Green Power and Carbon Offsets										33.68 P68: Regional Priority Credit (1.0-1.0 Points)										33.69 P69: Regional Priority Credit (1.0-1.0 Points)																																																																															
5.22 EA22: Green Power and Carbon Offsets										33.70 P70: Regional Priority Credit (1.0-1.0 Points)										33.71 P71: Regional Priority Credit (1.0-1.0 Points)																																																																															
5.23 EA23: Green Power and Carbon Offsets										33.72 P72: Regional Priority Credit (1.0-1.0 Points)										33.73 P73: Regional Priority Credit (1.0-1.0 Points)																																																																															
5.24 EA24: Green Power and Carbon Offsets										33.74 P74: Regional Priority Credit (1.0-1.0 Points)										33.75 P75: Regional Priority Credit (1.0-1.0 Points)																																																																															
5.25 EA25: Green Power and Carbon Offsets										33.76 P76: Regional Priority Credit (1.0-1.0 Points)										33.77 P77: Regional Priority Credit (1.0-1.0 Points)																																																																															
5.26 EA26: Green Power and Carbon Offsets										33.78 P78: Regional Priority Credit (1.0-1.0 Points)										33.79 P79: Regional Priority Credit (1.0-1.0 Points)																																																																															
5.27 EA27: Green Power and Carbon Offsets										33.80 P80: Regional Priority Credit (1.0-1.0 Points)										33.81 P81: Regional Priority Credit (1.0-1.0 Points)																																																																															
5.28 EA28: Green Power and Carbon Offsets										33.82 P82: Regional Priority Credit (1.0-1.0 Points)										33.83 P83: Regional Priority Credit (1.0-1.0 Points)																																																																															
5.29 EA29: Green Power and Carbon Offsets										33.84 P84: Regional Priority Credit (1.0-1.0 Points)										33.85 P85: Regional Priority Credit (1.0-1.0 Points)																																																																															
5.30 EA30: Green Power and Carbon Offsets										33.86 P86: Regional Priority Credit (1.0-1.0 Points)										33.87 P87: Regional Priority Credit (1.0-1.0 Points)																																																																															
5.31 EA31: Green Power and Carbon Offsets										33.88 P88: Regional Priority Credit (1.0-1.0 Points)										33.89 P89: Regional Priority Credit (1.0-1.0 Points)																																																																															
5.32 EA32: Green Power and Carbon Offsets										33.90 P90: Regional Priority Credit (1.0-1.0 Points)										33.91 P91: Regional Priority Credit (1.0-1.0 Points)																																																																															
5.33 EA33: Green Power and Carbon Offsets										33.92 P92: Regional Priority Credit (1.0-1.0 Points)										33.93 P93: Regional Priority Credit (1.0-1.0 Points)																																																																															
5.34 EA34: Green Power and Carbon Offsets										33.94 P94: Regional Priority Credit (1.0-1.0 Points)										33.95 P95: Regional Priority Credit (1.0-1.0 Points)																																																																															
5.35 EA35: Green Power and Carbon Offsets										33.96 P96: Regional Priority Credit (1.0-1.0 Points)										33.97 P97: Regional Priority Credit (1.0-1.0 Points)																																																																															
5.36 EA36: Green Power and Carbon Offsets										33.98 P98: Regional Priority Credit (1.0-1.0 Points)										33.99 P99: Regional Priority Credit (1.0-1.0 Points)																																																																															
5.37 EA37: Green Power and Carbon Offsets										33.100 P100: Regional Priority Credit (1.0-1.0 Points)										33.101 P101: Regional Priority Credit (1.0-1.0 Points)																																																																															
5.38 EA38: Green Power and Carbon Offsets										33.102 P102: Regional Priority Credit (1.0-1.0 Points)										33.103 P103: Regional Priority Credit (1.0-1.0 Points)																																																																															
5.39 EA39: Green Power and Carbon Offsets										33.104 P104: Regional Priority Credit (1.0-1.0 Points)										33.105 P105: Regional Priority Credit (1.0-1.0 Points)																																																																															
5.40 EA40: Green Power and Carbon Offsets										33.106 P106: Regional Priority Credit (1.0-1.0 Points)										33.107 P107: Regional Priority Credit (1.0-1.0 Points)																																																																															
5.41 EA41: Green Power and Carbon Offsets										33.108 P108: Regional Priority Credit (1.0-1.0 Points)										33.109 P109: Regional Priority Credit (1.0-1.0 Points)																																																																															
5.42 EA42: Green Power and Carbon Offsets										33.110 P110: Regional Priority Credit (1.0-1.0 Points)										33.111 P111: Regional Priority Credit (1.0-1.0 Points)																																																																															
5.43 EA43: Green Power and Carbon Offsets										33.112 P112: Regional Priority Credit (1.0-1.0 Points)										33.113 P113: Regional Priority Credit (1.0-1.0 Points)																																																																															
5.44 EA44: Green Power and Carbon Offsets										33.114 P114: Regional Priority Credit (1.0-1.0 Points)										33.115 P115: Regional Priority Credit (1.0-1.0 Points)																																																																															
5.45 EA45: Green Power and Carbon Offsets										33.116 P116: Regional Priority Credit (1.0-1.0 Points)										33.117 P117: Regional Priority Credit (1.0-1.0 Points)																																																																															
5.46 EA46: Green Power and Carbon Offsets										33.118 P118: Regional Priority Credit (1.0-1.0 Points)										33.119 P119: Regional Priority Credit (1.0-1.0 Points)																																																																															
5.47 EA47: Green Power and Carbon Offsets										33.120 P120: Regional Priority Credit (1.0-1.0 Points)										33.121 P121: Regional Priority Credit (1.0-1.0 Points)																																																																															
5.48 EA48: Green Power and Carbon Offsets										33.122 P122: Regional Priority Credit (1.0-1.0 Points)										33.123 P123: Regional Priority Credit (1.0-1.0 Points)																																																																															
5.49 EA49: Green Power and Carbon Offsets										33.124 P124: Regional Priority Credit (1.0-1.0 Points)										33.125 P125: Regional Priority Credit (1.0-1.0 Points)																																																																															
5.50 EA50: Green Power and Carbon Offsets										33.126 P126: Regional Priority Credit (1.0-1.0 Points)										33.127 P127: Regional Priority Credit (1.0-1.0 Points)																																																																															
5.51 EA51: Green Power and Carbon Offsets										33.128 P128: Regional Priority Credit (1.0-1.0 Points)										33.129 P129: Regional Priority Credit (1.0-1.0 Points)																																																																															
5.52 EA52: Green Power and Carbon Offsets										33.130 P130: Regional Priority Credit (1.0-1.0 Points)										33.131 P131: Regional Priority Credit (1.0-1.0 Points)																																																																															
5.53 EA53: Green Power and Carbon Offsets										33.132 P132: Regional Priority Credit (1.0-1.0 Points)										33.133 P133: Regional Priority Credit (1.0-1.0 Points)																																																																															
5.54 EA54: Green Power and Carbon Offsets										33.134 P134: Regional Priority Credit (1.0-1.0 Points)										33.135 P135: Regional Priority Credit (1.0-1.0 Points)																																																																															
5.55 EA55: Green Power and Carbon Offsets										33.136 P136: Regional Priority Credit (1.0-1.0 Points)										33.137 P137: Regional Priority Credit (1.0-1.0 Points)																																																																															
5.56 EA56: Green Power and Carbon Offsets										33.138 P138: Regional Priority Credit (1.0-1.0 Points)										33.139 P139: Regional Priority Credit (1.0-1.0 Points)																																																																															
5.57 EA57: Green Power and Carbon Offsets										33.140 P140: Regional Priority Credit (1.0-1.0 Points)										33.141 P141: Regional Priority Credit (1.0-1.0 Points)																																																																															
5.58 EA58: Green Power and Carbon Offsets										33.142 P142: Regional Priority Credit (1.0-1.0 Points)										33.143 P143: Regional Priority Credit (1.0-1.0 Points)																																																																															
5.59 EA59: Green Power and Carbon Offsets										33.144 P144: Regional Priority Credit (1.0-1.0 Points)										33.145 P145: Regional Priority Credit (1.0-1.0 Points)																																																																															
5.60 EA60: Green Power and Carbon Offsets										33.146 P146: Regional Priority Credit (1.0-1.0 Points)										33.147 P147: Regional Priority Credit (1.0-1.0 Points)																																																																															
5.61 EA61: Green Power and Carbon Offsets										33.148 P148: Regional Priority Credit (1.0-1.0 Points)										33.149 P149: Regional Priority Credit (1.0-1.0 Points)																																																																															
5.62 EA62: Green Power and Carbon Offsets										33.150 P150: Regional Priority Credit (1.0-1.0 Points)										33.151 P151: Regional Priority Credit (1.0-1.0 Points)																																																																															
5.63 EA63: Green Power and Carbon Offsets										33.152 P152: Regional Priority Credit (1.0-1.0 Points)										33.153 P153: Regional Priority Credit (1.0-1.0 Points)																																																																															
5.64 EA64: Green Power and Carbon Offsets										33.154 P154: Regional Priority Credit (1.0-1.0 Points)										33.155 P155: Regional Priority Credit (1.0-1.0 Points)																																																																															
5.65 EA65: Green Power and Carbon Offsets										33.156 P156: Regional Priority Credit (1.0-1.0 Points)										33.157 P157: Regional Priority Credit (1.0-1.0 Points)																																																																															
5.66 EA66: Green Power and Carbon Offsets										33.158 P158: Regional Priority Credit (1.0-1.0 Points)										33.159 P159: Regional Priority Credit (1.0-1.0 Points)																																																																															
5.67 EA67: Green Power and Carbon Offsets										33.160 P160: Regional Priority Credit (1.0-1.0 Points)										33.161 P161: Regional Priority Credit (1.0-1.0 Points)																																																																															
5.68 EA68: Green Power and Carbon Offsets										33.162 P162: Regional Priority Credit (1.																																																																																									

Sustainability Path – NE CHPS:

100000 Verified: 110 to 159 points (85 for renovation)
 Verified Leader: 160+ points (135 for renovation)
 Date: 03/16/2021

Category	Points	Sub-category	Points
10 8 13	21	Integration & Innovation	
3	1	Integrated Design	3
1	1	Educational Display	1
2	1	Crime Prevention	2
2	2	Enhanced Integrated Design	2
1	1	District Level Commitment	1
1	1	School Master Plan	1
1	1	High Performance Transition Plan	1
1	1	Demonstration Area	1
2	3	Educational Integration	2
3	3	Climate Change Action	3
4	3	Innovation	4
8 13 1	22	Sites	
2	2	Site Selection	2
2	2	Site and Building Best Practices	2
3	3	Environmentally Sensitive Land	3
1	1	Minimize Site Disturbance	1
1	1	Construction Site Erosion Control and Sedimentation	1
1	1	Post Construction Stormwater Management	1
1	1	Located Near Public Transportation	1
2	2	Central Location	2
1	1	Zero-Use Facilities	1
2	2	Human-Powered Transportation	2
1	1	Reduce Heat Islands - Landscaping & Sites	1
1	1	Reduce Heat Islands - Cool Roofs and Green Walls	1
2	2	Avoid Light Pollution and Unnecessary Lighting	2
1	1	Use Locally Native Plants for Landscapes	1
1	1	School Gardens	1
17 4 0	21	Water	
8	1	Maximum Reduction in Potable Water Use	8
5	1	Ingestion and Exterior Water Budget Use Reduction	5
1	1	Ingestion Systems and Commissioning	1
2	1	Reduce Potable Water for Storage Convenience	2
2	1	Reduce Potable Water Use for Non-Recreational Landscaping	2
1	1	Reduce Potable Water Use for Recreational Landscaping	1
2	2	Rainwater Collection and Storage	2
2	2	Water Management Systems	2
22 29 2	64	Energy	
6	4	Energy Performance	6
4	4	Commissioning	4
1	1	Environmentally Preferable Purchases	1
2	2	Local Energy Efficiency Incentive and Assistance	2
22	25	Superior Energy Performance	22
3	3	ZeroNet Energy Capable	3
1	1	Additional Commissioning Qualifications	1
1	1	Envelope Commissioning	1
1	1	Enhanced Commissioning	1
2	2	Energy Management System	2
2	2	Advanced Energy Management System and Submetering	2
2	2	Natural Ventilation and Energy Conservation Interlocks	2
1	1	Variable Air Volume Systems	1
1	1	Renewable Energy Performance Monitoring	1
1	1	Electric Vehicle Charging	1
9 5 5	19	Materials & Waste Management	
2	2	Storage & Collection of Recyclables	2
2	2	Maximum Construction Site Waste Management	2
1	1	Construction Site Waste Management	1
1	1	Single Attribute - Recycled Content	1
1	1	Single Attribute - Rapidly Renewable Materials	1
1	1	Single Attribute - Certified Wood	1
1	1	Locally Produced Materials	1
2	2	Multi-Attribute Materials Selection	2
2	2	Building Reuse - Exterior (Reno Only)	2
1	1	Building Reuse - Interior	1
1	1	Single Attribute - Materials Reuse	1
1	1	Health Product Related Information Reporting	1



CAOLO & BIENIEK ASSOCIATES, INC.
 ARCHITECTURE PLANNING INTERIOR DESIGN
 521 East Street | 1 413.594.2800
 Chicopee, Massachusetts | www.cbaarchitects.net

Sustainability Path:

LEED for Schools:

- 40 Points Min. and Exceed Energy Code by 10% (20% for additional MSBA Incentive Points)
- Prerequisites Are Not Assigned Points
- Slightly Higher Certification Fees
- High Level of Support/ Efficient Reviews
- Higher Design and Construction Burden w/ Lower Burden on City/ School Department
- Favors Urban Sites

NE CHPS:

- 110 Points Min. (85 Points for Add-Reno) and Exceed Energy Code by 10% (20% for MSBA Incentive)
- Prerequisites Are Assigned Points
- Slightly Lower Certification Fees
- Higher Focus on Operations – Very Active Involvement by School Admin is Necessary
- Smaller Organizational Budget Can Lead to Longer Review Times/ Delays



CAOLO & BIENIEK ASSOCIATES, INC.
 ARCHITECTURE PLANNING INTERIOR DESIGN
 521 East Street | 1 413.594.2800
 Chicopee, Massachusetts | www.cbaarchitects.net

DESIGN ALTERNATIVE SUMMARY:

Preliminary Design Program (PDP) Is Complete and Preferred Schematic (PSR) Is Focusing On a Consolidated School

PSR Design Alternatives:

- **Base Repair** – Required by MSBA to Serve as a Baseline Model
- **Add-Reno**, Single Story
- **New** Construction, **1-Story** w/ **Staggered Move-In**
- **New** Construction, **2-Story** w/ **Staggered Move-In**

- **New** Construction, **3-Story** w/ **Single Move-In**
- **New** Construction, **2-Story** w/ **Single Move-In**



CAOLO & BIENIEK ASSOCIATES, INC.
ARCHITECTURE PLANNING INTERIOR DESIGN
 521 East Street 1 413 594 2800
 Chicopee, Massachusetts www.cbearchitects.net

PROJECT GOALS:

- Provide **Healthy, Flexible Environment** for Learning
- Support the **Educational Program**
- Foster **Positive Relationship** between **School and Community**
- Introduce **Pre-K Program** to Franklin Avenue
- Support Increased **Project-Based Learning**
- Provide Connections to **the Natural World**
- Support **Anytime-Anywhere Learning**
- Organize Grade Levels into **Academic Neighborhoods**
- Support **Robust Counseling** Program
- Provide Clear **Public** and **Academic Zones**
- Support **Large** and **Small Performances**
- Increase **Presence on Franklin Street** and Minimize Traffic in Neighborhood



NEIGHBORHOOD CONCEPTS:

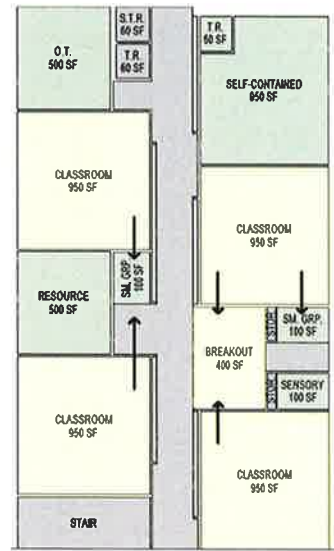
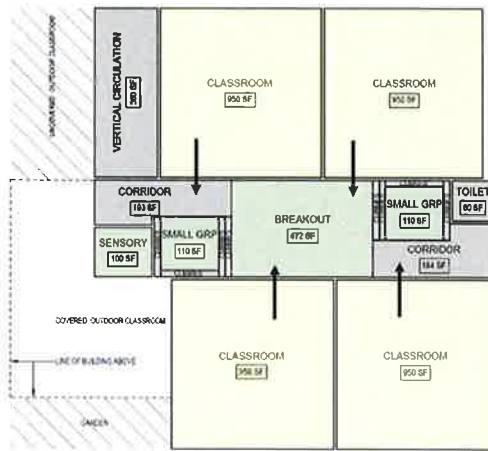

BASE REPAIR

Pros:

- Structurally Sound
- Code Compliant
- Barrier-Free

Cons:

- No Educational Benefits
- No Site Improvements (Access, Parking, Etc.)
- Excludes Abner Gibbs Students

Building Stabilization/ Code Compliance

- Gross Square Footage: **33,003 gsf**
- Program Square Footage: **22,203 nsf**
- Grossing Factor: **1.49**

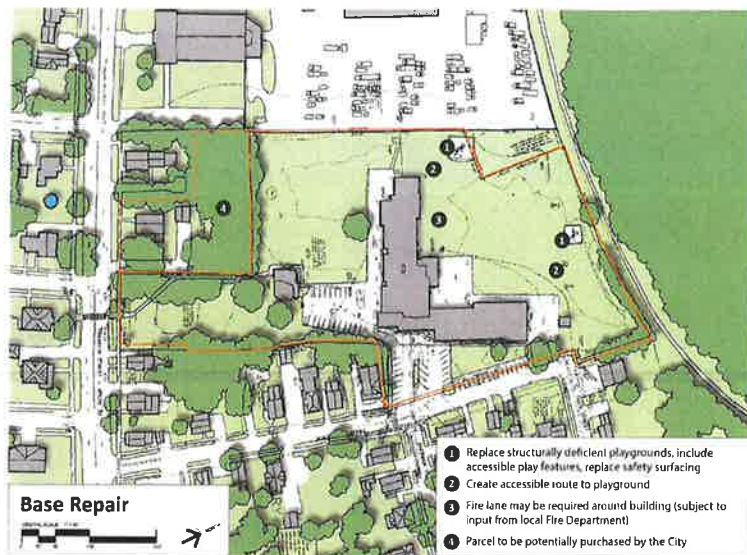

NEW CONSTRUCTION, 2-STORY, STAGGERED MOVE

Pros:

- Healthy Environment
- Flexible Spaces
- Franklin St. Presence
- Pre-K
- Neighborhoods
- Clear Zoning
- PBL Opportunities
- Robust Counseling
- Performance Options
- Nature Connections
- Smaller Footprint
- Anytime Anywhere Learning

Cons:

- Staggered Move



Consolidated Enrollment; New Construction

Gross Square Footage: **88,995 gsf**

Program Square Footage: **59,559 nsf**

Grossing Factor: **1.49**



NEW CONSTRUCTION, 3-STORY, SINGLE MOVE

Pros:

- One Move
- Healthy Environment
- Flexible Spaces
- Franklin St. Presence
- Pre-K
- Neighborhoods
- Clear Zoning
- PBL Opportunities
- Robust Counseling
- Performance Options
- Nature Connections
- Smaller Footprint
- Anytime Anywhere Learning

Cons:

- Disproportionate Scale



Consolidated Enrollment; New Construction

Gross Square Footage: **88,562 gsf**

Program Square Footage: **59,559 nsf**

Grossing Factor: **1.49**



NEW CONSTRUCTION, 2-STORY, SINGLE MOVE

Pros:

- One Move
- Healthy Environment
- Flexible Spaces
- Franklin St. Presence
- Pre-K
- Neighborhoods
- Clear Zoning
- PBL Opportunities
- Robust Counseling
- Performance Options
- Nature Connections
- Smallest Footprint
- Anytime Anywhere Learning

Cons:

- Multi-Story Building

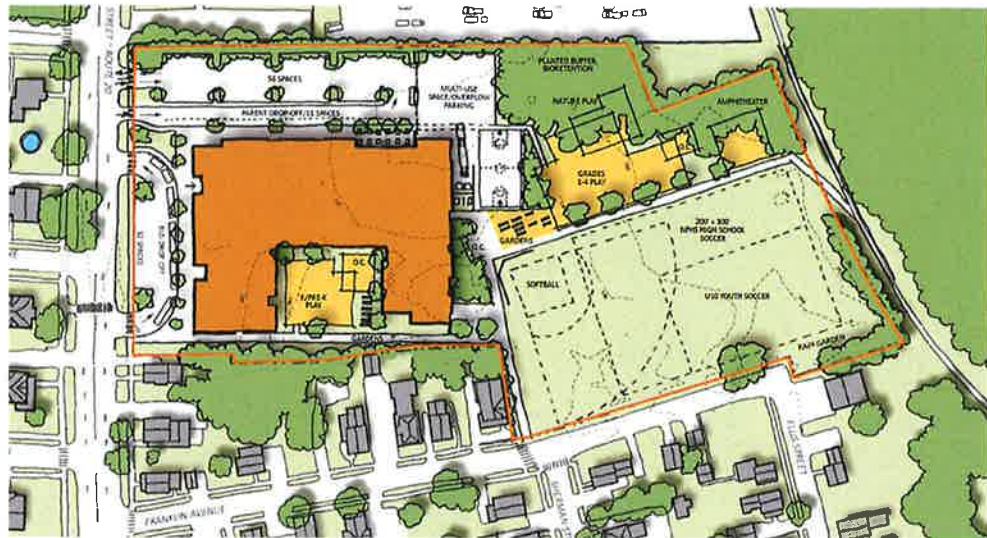

Consolidated Enrollment; New Construction

Gross Square Footage: **88,227 gsf**

Program Square Footage: **59,559 nsf**

Grossing Factor: **1.48**



CONCEPT PLAN

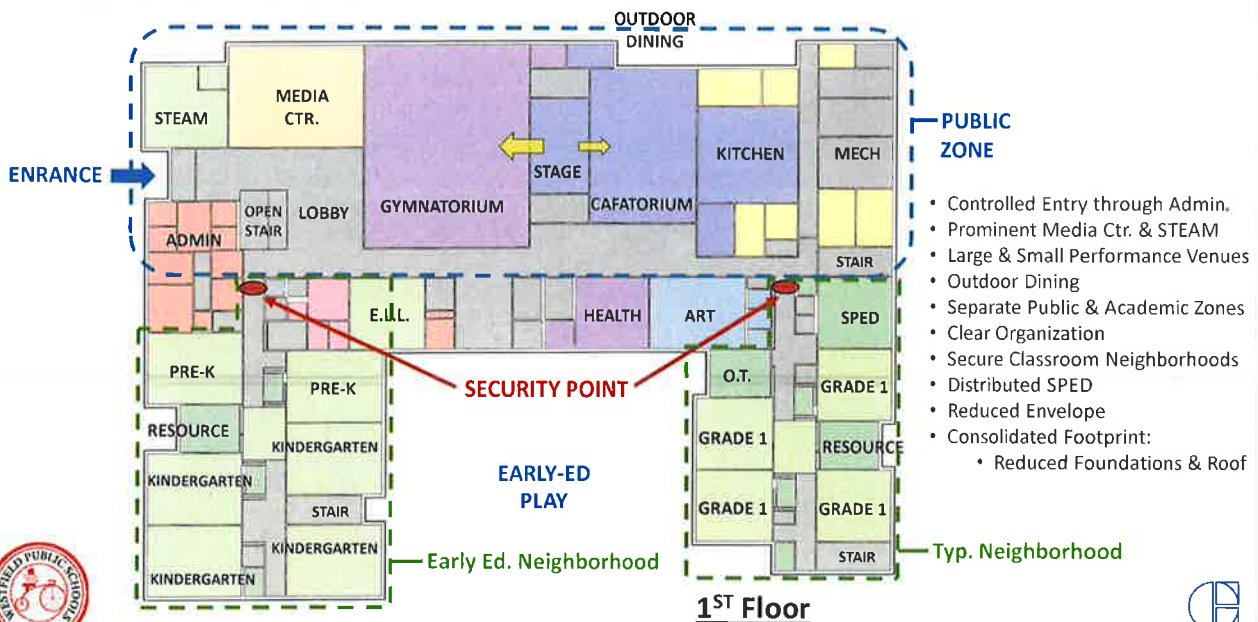

CONCEPT PLAN

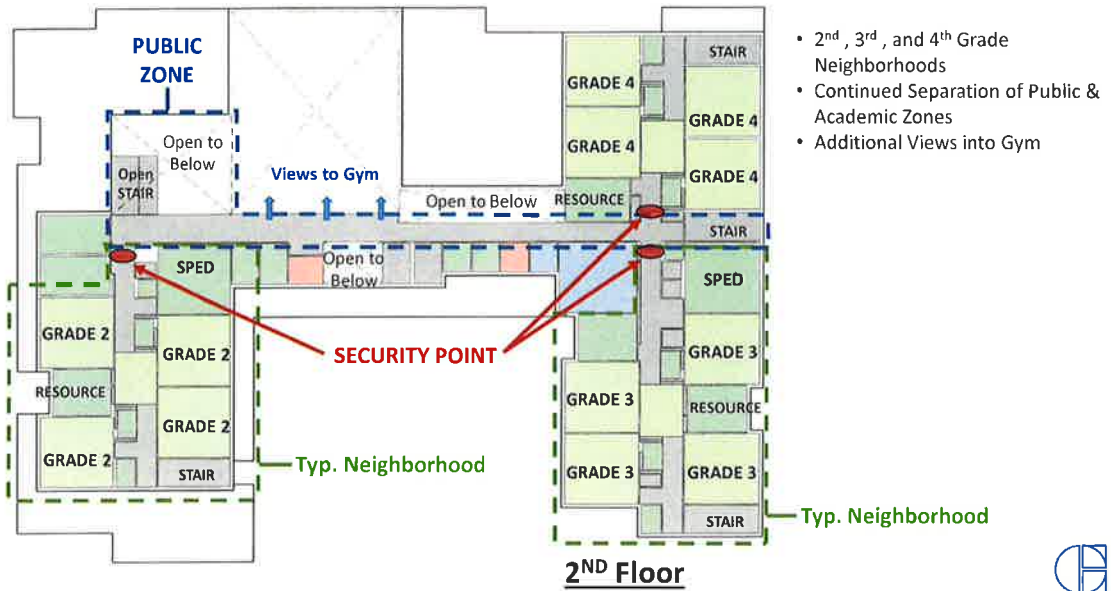

THANK YOU

